

WPE 3V2

Wireless PE Beam

Quick Installation Guide

MAIN KIT COMPONENTS

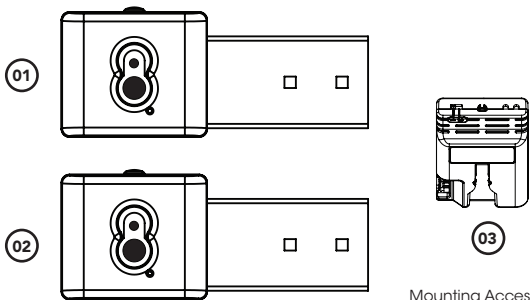

Mounting Accessory
Envelope & Batteries
Not Pictured

Key	Part
01	Transmitter TX / Receiver RX
02	Transmitter TX / Receiver RX
03	Base Station BS

SAFETY BEAM WARNINGS



When using Safety beams, the doorway must be clear of all obstructions and persons at all times. The location of the beams and manner in which they are installed might not give safety protection at all times.

The sensors need to be 100mm above the floor level, however, the exact position must be chosen in such a manner that it suits the application, the environmental conditions and provides maximum safety protection.

When using auto close mode, a Safety beam must be fitted correctly and tested for operation at regular intervals. Extreme caution is recommended when using auto close mode. All safety rules must be followed.



Disconnect the power cord from mains power and battery backup (if installed) before making any repairs or removing covers on openers.



Fall from ladder

Ensure ladder is the correct type for job.

Ensure ladder is on flat ground.

Ensure user has 3 points of contact while on ladder.

Entrapment

Ensure the garage door is in good working order by undertaking regular servicing.

Safety beams must be installed if the closing force at the bottom edge of the door exceeds 400N (40kg)

SAFETY BEAM INSTALLATIONS

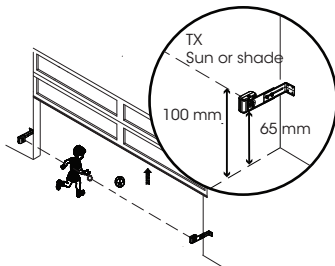

The Safety Beam Kit provides additional safety by preventing the shutter closing when the beam is blocked by a car, child etc.

The transmitter and receiver need to be placed in line of sight, with the beam 100mm above the ground level (as per AS/NZS 60335-2-95:2020). This can be achieved by ensuring the bottom of the receiver and transmitter are 65mm above ground level. They should also be placed as close as possible to the door opening with the receiver (RX) in shade and the transmitter (TX) in sun or shade.



WARNING! The Opener must be fitted with Safety Beams if:

- The closing force at the bottom edge of the door exceeds 400N (40kg) and/or;
- The opener has a smart device fitted to operate the door, when not in line-of-sight as per; AS/NZS 60335-2-95:2020

INSERT THE BATTERIES

STEP ONE

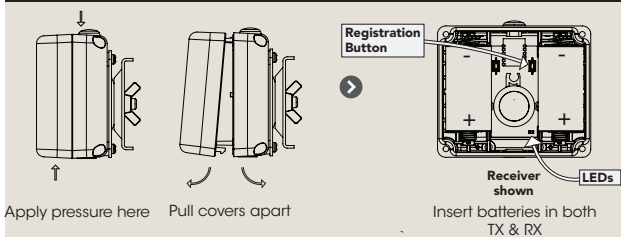

STEP TWO

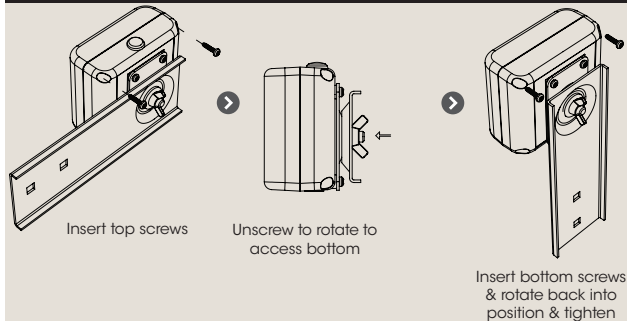

MOUNT THE BRACKETS

STEP THREE

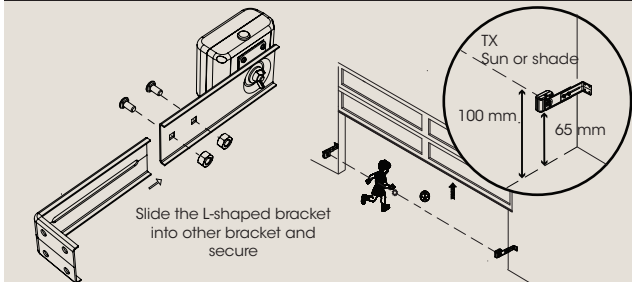

Mount the brackets to the wall using a minimum of 4 fixings (not supplied) appropriate to the substrate. Install as close to the path of the door as possible. Take note of the install warnings and height requirements above.

CONNECT THE BASE STATION

STEP FOUR



WARNING! Ensure power is disconnected from opener before removing any covers.

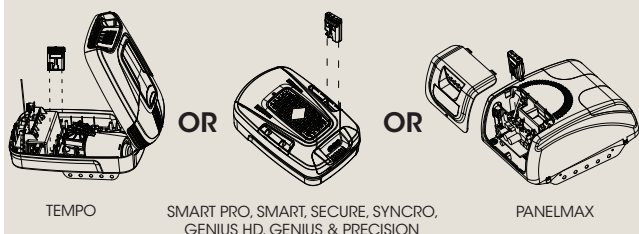

ALIGNING THE SAFETY BEAMS

STEP FIVE

Switch Power on to opener (door position not set yet).

LED's will flicker on **ALL** parts, to indicate successful Bluetooth connection. (Flickering stops after 30 seconds).

Receiver Red LED ON = aligned (Go to **STEP SEVEN**)

Receiver Red LED OFF = not aligned (Go to **STEP SIX**)

STEP SIX

The opener beam alignment feature can be used to align beams via the beeper and main light as a guide.

move in arrow directions

bright = aligned
OR
dull & sound = not aligned / blocked



If the light does not dim and the beeper does not sound when an object blocks the beam then the beam is not being detected by the opener. Check connection to opener, batteries and alignment.

STEP SEVEN

When beams are aligned, continue with opener instructions to Set Limits. If the opener has previously been installed, no need to reset limits.

CONNECTING & DISCONNECTING

If disconnecting or reconnecting the base station module to the opener, remember to;

STEP ONE

Remove controls cover

MODE

Press repeatedly

till gear LED lit

STEP TWO

STOP SET

HOLD for 2 secs

till 3 beeps are heard

STEP THREE

When reconnecting

Alignment Mode is entered. Ensure Alignment. Align Safety Beams

MODE

OFF

Then refit controls cover

Re-registering is required every time an accessory is removed.



If an Auto-Lock is installed ensure that the Auto-Lock is always on channel 2. The channel can be changed by sliding the switch in either direction.

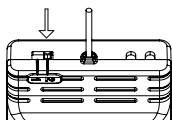

TROUBLESHOOTING

Symptom	Possible cause	Remedy
RED Receiver LED is off and can not close the door	Receiver and transmitter not aligned properly	Realign receiver and the transmitter
	Beam is obstructed	Remove obstruction from the path of the beam
Door will not close	Safety Beam not working	To access safety close mode, hold the transmitter button for 6 seconds, let it go, then press and hold again until door is fully closed.
	Safety Beam battery flat	Replace the batteries
Main light on opener flashes 4 times at the start and end of the cycle LED on the receiver/transmitter started to flash during operation of the door	The battery in the receiver/transmitter is running low	Replace the batteries

LED LIGHT STATUS

Product	Yellow LED ★	Red RX ★ / Green TX ★ LEDs
Transmitter (Yellow & Green LEDs)	flickering = connected	solid ON = active, door is moving OR = in alignment mode / limit set mode
Receiver (Yellow & Red LEDs)	flickering = connected	solid ON = active, door is moving beam is clear OFF = beam is blocked or opener is not connected

MAINTENANCE

To ensure a long and trouble free life for your Safety Beams, the following is recommended:

- Periodically test the Safety Beam is operating efficiently by obstructing either the transmitter or receiver during the openers operation to ensure the door stops.
- If the Safety Beams are located in a very dusty / dirty environment make sure to clean transmitter and receiver lenses for optimal performance.
- Replace batteries in transmitter or receiver when the opener flashes 4 times at the start and end of operation of the door.